

Gateway recommends Microsoft® Windows® XP Professional.

GATEWAY® E-2600 DESKTOP

Mainstream Performer



Gateway®

Gateway's Innovative BTX Design

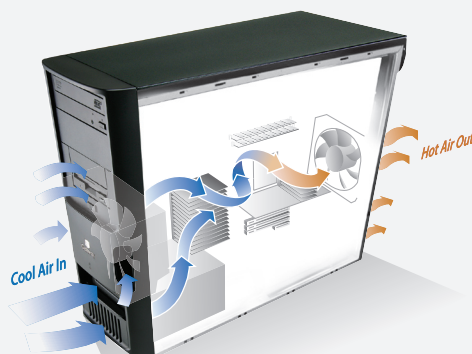

THE BTX ADVANTAGE

Over the past decade internal PC components have evolved delivering increased performance while creating significantly more heat. New BTX technology was designed to optimize cooling, extending the life and reliability of the system. Gateway has improved on the new BTX reference design with its 3-bay, 6-bay and 7-bay E-Series chassis.

A direct flow wind tunnel inside the system.

Gateway's BTX designs include oversized fans that spin more slowly and minimize noise, yet move air over key components and hard drives. Dual fan systems are tuned to work together, optimizing the volume of air moving over the system.

A new motherboard design that works with the wind tunnel to keep the system cool.

Gateway's BTX motherboards have a more direct airflow path to keep the CPU, memory and graphics cards cooler. With the large system fans efficiently moving air over the motherboard, separate fans are not needed for these components – increasing reliability.



E-2600S
Space-Saving 3-Bay BTX

E-2600D
Expandable 6-Bay BTX

IDEAL BALANCE OF PERFORMANCE AND VALUE

The Gateway® E-2600 Desktop delivers mainstream performance with just the right feature set, ideal for mass deployment into areas where performance and serviceability matter as much as cost. The platform is equipped with the reliability, manageability, flexibility, plus the service and support, and customization your organization demands.

MAINSTREAM PERFORMANCE with the Latest Technology Including Intel® Pentium® 4 Processor and Intel® Pentium® D Processor with Intel® Dual-Core Processing Options, and PCI Express x16 Graphics Slot

INCREASED RELIABILITY, SERVICEABILITY AND FLEXIBILITY with Gateway's BTX Tool-Free Desktop Design in Space Saving 3-Bay or Expandable 6-Bay Case Options

ENHANCED SYSTEM MAINTENANCE, ASSET MANAGEMENT and Software Rollouts with Gateway® Client Manager including Remote Management Capabilities

MANAGEABILITY IN A MAINSTREAM PLATFORM with Consistent Software Images and Hardware Platform plus Predictable Lifecycles

MAXIMUM USER AND SYSTEM UPTIME with Professional Level Service and Support, including a Standard 3-Year Limited Warranty, Next-Business-Day Replacement Parts and On-Site Service³

ENHANCED SECURITY WITH GATEWAYSHIELD™ to Help Protect Your Organization's Hardware, Internet Security and Data



GATEWAY® E-2600 SPECIFICATIONS:



Processor Options:	Intel® Pentium® D Processor 900 Sequence and Intel® Extended Memory 64 Technology (Intel® EM64T)
Operating System:	Microsoft® Windows® XP Professional Edition SP2
Chipset:	ATI™ Radeon® Xpress 200
Front Side Bus:	800MHz
Memory:	533 or 667MHz DDR2 SDRAM
Hard Drives:	7200 RPM Serial ATA Hard Drives ²
Graphics:	Integrated Radeon® X300 Based Graphics with up to 256 MB shared memory
Floppy and/or Media Reader:	1.44MB 3.5" Floppy, 9-1 Media Card Reader
Optical Drive Options:	48x CD-ROM; 16x DVD; 48x/32x/48x CD-RW; 48x/32x/48x/16x CD-RW/DVD Combo Drive; 16x Double-Layer Multi-Format DVD Writer (DVD±R/±RW/CD-R/RW)
Connectivity Options:	Integrated Realtek10/100/1000 Ethernet; 1394 IEEE PCI Card
Audio Options:	Integrated 5.1 Audio Support
Expansion Slots:	Four: Two PCI (6-Bay and 3-Bay), PCI-Express x1 (6-Bay and 3-Bay), PCI-Express x16 (6-Bay and 3-Bay)
External Ports:	Six USB 2.0 Ports (4 back, 2 front)
Case Options:	6-Bay Mini-Tower, 3-Bay Small Form Factor
Manageability Software:	Gateway Desktop Client Manager
Certification:	Energy Star® Compliant
Limited Warranty Options:	3- to 5-Year Limited Warranty Plans ³
Keyboard:	Optional 104+ Keyboard
Mouse:	Optional 2-Button Wheel Mouse (PS/2); Optional 2-Button Optical Wheel Mouse (USB)
Case Dimensions:	6-Bay: 17.6"D x 7.1"W x 15.2"H 3-Bay: 14.4"D x 4.1"W x 16.4"H

RECOMMENDED E-SERIES SERVICES

Keep Your Hard Drive Service Plan⁴

Protect your organization by securing your data with a service plan for your hard drives. Cost-effectively retain your hard drive in the event that a new drive is installed under warranty. Choose how your data is destroyed or recovered, giving you complete control over confidential information.



System Installation Services⁵

Simplify installation with quick, seamless set up of new Gateway hardware by our local experts. Services are available in scalable pre-defined packages or customized proposals to meet your specific needs.

Extended Service Plan³

For premium service and support, our Total Protection Service Plan includes Gateway Priority Access with a dedicated team of certified technicians answering calls within 30 seconds or less plus Next-Business-Day Replacement Parts and Next-Business-Day On-Site Service.

Custom Integrated Solutions (CIS)

Improve product consistency, reduce delivery cycle time and reduce your IT workload with key CIS services including:

- Installation of Client-Supplied Software Images
- Custom Image Restoration CDs
- Installation of Custom Hardware and Security Components
- Application of Asset/Info Tags

Ask about our other technology management services.

RECOMMENDED E-SERIES UPGRADES:



Wireless Keyboard and Optical Mouse



Gateway Performance LCD Flat Panel Display



Gateway 9-Outlet Surge Protector



Gateway 512MB USB 2.0 Flash Drive



Lexmark E240n Network Laser Printer

Education Sales 800-211- 4952 | Federal Sales 800-216-2940

State & Local Sales 800-211-4952 | Business Sales 800-779-2000 | www.gateway.com/business

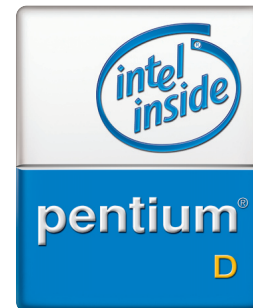

All offers valid in U.S. only and are subject to change without notice or obligation. May not be available through all sales channels. 1. Performance may vary. See www.intel.com for additional information. 2. Accessible capacity varies; MB=1 million bytes; GB=1 billion bytes. 3. Limited warranties and service agreements apply; visit gateway.com or call 1-800-846-2000 for a free copy. Service agreements are issued and performed by third parties. May not be available in all locations. On-site service technicians will be sent if necessary, following phone-based trouble shooting. Availability varies. Other conditions apply. 4. Offer available on E-Series desktops and Profile 5. Not available to consumer customers. All offers are subject to change without notice or obligation. Limited warranties and service agreements apply; visit gateway.com or call 1-800-846-2000 for a free copy. Not available in all areas. 5. Installation provided by third parties. Not available in remote locations. © 2006 Gateway Inc. All rights reserved. Gateway terms & conditions of sale apply. Intel, Intel Inside, the Intel Inside logo, Intel Centrino, the Intel Centrino logo and Pentium are trademarks or registered trademarks of Intel Corporation or its subsidiaries in the United States and other countries. Microsoft and Windows are registered trademarks of Microsoft Corporation. All other brands and product names are trademarks or registered trademarks of their respective companies. See important Microsoft activation requirements at www.gateway.com/ms-req. Not responsible for typographical errors. Ad Code: 128268